

IEC 80601-2-89 Figure CC.1 Wedge Tool

Medical Bed Entrapment Test Tool

Designed for medical bed opening safety evaluation, including wedge-shaped openings, V-shaped gaps and potential neck entrapment areas in children's medical beds.

IEC 80601-2-89:2025 Figure CC.1

Related IEC 60601-2-52 Figure CC.1

Mechanical Wedge Tool



Scan product page

www.dgkingpo.com

sales@kingpo.hk

+86-769-81627526

Product Overview

The IEC 80601-2-89 Figure CC.1 Wedge Tool is used for medical bed entrapment risk evaluation. It helps manufacturers and laboratories check whether openings, gaps or structural spaces in a medical bed may create a potential neck or body part entrapment hazard.

This tool is especially suitable for children's medical bed safety evaluation and can also support related IEC 60601-2-52 Figure CC.1 checks when required by the customer's test method, certification project or internal laboratory procedure.



Key Information

Main standard:	IEC 80601-2-89:2025 Figure CC.1
Related standard:	IEC 60601-2-52 Figure CC.1
Product name:	Wedge Tool
Test object:	Children's medical beds, medical beds and related bed systems
Test purpose:	Wedge-shaped opening, V-shaped gap and entrapment risk evaluation
Application areas:	Side rails, mattress support platform, headboard, footboard, bed frame openings and non-moving parts
Tool type:	Mechanical medical bed entrapment test tool
Material:	Aluminum alloy or specified material according to order requirement
Surface finish:	Anodized, coated or according to customer requirement

Main Value

Defined wedge geometry, stable structure and durable material help support repeatable medical bed gap inspection, product development verification and laboratory safety evaluation.

Standards and Test Background

Medical beds may contain openings between side rails, mattress support platforms, headboards, footboards, bed frames and other non-moving parts. If these areas are not properly designed, they may create entrapment risks during patient use.

IEC 80601-2-89:2025 Figure CC.1 defines the wedge tool used for specific medical bed opening and entrapment evaluation. IEC 60601-2-52 Figure CC.1 is also commonly referenced for related medical bed entrapment checks.



Laboratory angle view

Testing Principle

During testing, the wedge tool is applied to the required medical bed opening or gap area according to the applicable standard procedure. The operator checks whether the tool can enter, contact or indicate a potentially unsafe opening condition based on the specified test method.

Applications and Use Cases

The IEC 80601-2-89 Figure CC.1 Wedge Tool is used for medical bed opening safety evaluation, especially for checking wedge-shaped openings, V-shaped gaps and potential entrapment areas in side rails, mattress support platforms, headboards, footboards, bed frame spaces and other non-moving parts.

It is suitable for medical bed design verification, children's medical bed safety evaluation, routine production quality control, pre-compliance testing and third-party laboratory assessment. Typical users include medical bed manufacturers, hospital bed suppliers, testing laboratories, certification support teams and quality inspection organizations.

Technical Parameters

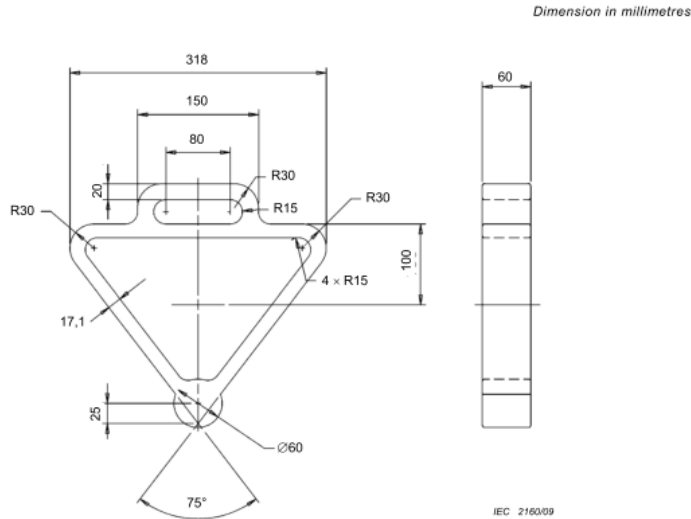

Material: Aluminium
Weight: 3,34 kg

Figure CC.1 – Wedge tool

Drawing Notes

Figure:
CC.1 - Wedge tool

Material:
Aluminium

Weight:
3.34 kg

Dimension unit:
Millimetres

Use:
Medical bed entrapment evaluation

Key Specifications

Item	Specification	Remark or Notes
Product Name	Wedge Tool	Medical bed entrapment test tool
Main Standard	IEC 80601-2-89:2025 Figure CC.1	Core product page standard
Related Standard	IEC 60601-2-52 Figure CC.1	For related medical bed checks
Product Type	Mechanical test tool	For gap and opening evaluation
Test Object	Children's medical beds and related bed systems	According to applicable test method
Application Areas	Side rails, mattress platform, headboard, footboard, frame openings	Actual positions depend on procedure
Documentation	Dimensional inspection report / calibration certificate	According to order requirement
Customization	Marking, color, material, storage case	Available upon request



Operation and Test Notes

Before testing, operators should confirm the applicable standard edition, bed type, test area and laboratory procedure. The wedge tool should be used only for the specified IEC 80601-2-89 or related IEC 60601-2-52 medical bed entrapment evaluation.

- Confirm the applicable standard and test area before use
- Do not use the wedge tool as a general-purpose measuring gauge
- Protect the tool from impact, deformation and surface damage
- Perform dimensional verification if dropped or visibly damaged

Metrological Integrity & Validation

Each wedge tool can be inspected before delivery according to the required drawing and standard-related geometry. Dimensional inspection report, factory verification record or calibration certificate can be provided according to order requirements.

Regular dimensional verification is recommended for frequent laboratory or production QC use. The tool should be protected from impact, deformation, corrosion and surface damage, and should be rechecked if visible damage or abnormal wear is found.

Technical Inquiry and Configuration Support

To confirm the correct wedge tool configuration, please send us your applicable standard and medical bed test requirements. KingPo can provide configuration suggestions for design verification, routine quality control, pre-compliance testing and certification preparation.

Applicable standard:	IEC 80601-2-89 / IEC 60601-2-52
Bed type:	Children's medical bed or related system
Test area:	Side rail, mattress platform, headboard, footboard
Documentation:	Inspection report, calibration certificate or verification record



Scan for details
Product page & inquiry

KingPo Technology Development Limited

Factory Address: No.9 University Road, Songshan Lake, Dongguan City, Guangdong Province 523770, China
Tel: +86-769-81627526 | Email: sales@kingpo.hk | Website: www.dgkingpo.com